

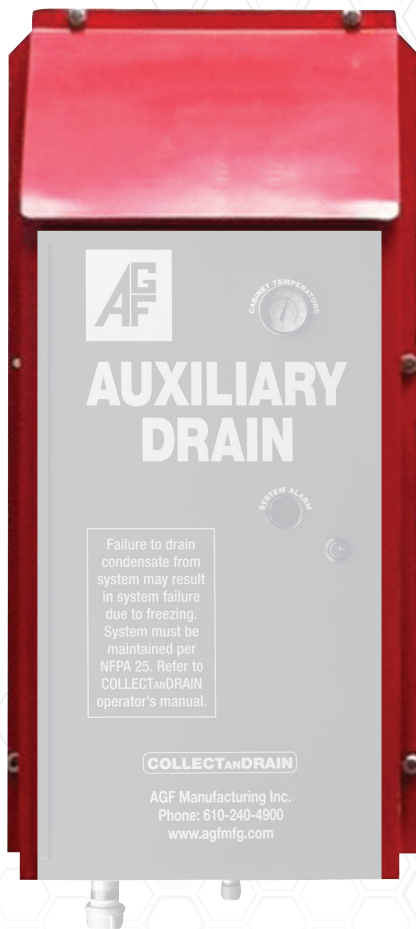

COLLECT_{AND}DRAIN[®]

Model 5680/5690



Installation Manual

www.agfmfg.com



COLLECTANDRAIN®

Outdoor Cover & Mounting Kit Installation Instructions

TABLE OF CONTENTS

Model 5680A Outdoor Cover Assembly

Inspection	3
Installation.....	3-4

Model 5690A Mounting Kit Assembly and Outdoor Cover

Inspection	5
Installation.....	5-7

AGF Manufacturing
100 Quaker Lane • Malvern, PA 19355

Phone: 610-240-4900
techsupport@agfmfg.com

www.agfmfg.com

Model 5680A

Outdoor Cover Assembly

INSTALLATION INSTRUCTIONS

The COLLECT_{AND}DRAIN Model 5680A Outdoor Cover Assembly installs directly over the 5400, 5450, or 5500 models. It is designed to mount flush against a flat wall or other secure structure using the holes in its mounting flange (3/8"). AGF recommends using mounting fasteners (not provided) suitable for the surface to which it is being mounted. ***If the cabinet is being mounted to a non-standard wall (I-beam or round bollard), or where standoffs are required on a standard wall a Model 5690A Mounting Kit Assembly is REQUIRED, follow the Mounting Kit Assembly and Outdoor Cover instructions on page 5.***

Inspection:

Unpack the Model 5680A Outdoor Cover and carefully inspect it for any damage caused during shipping. Verify that all contents below are included.

Each M5690A includes:

- 5680: Outdoor Cover
- 5669: Tie Down
- 5582: Four (4) 5/16" Stainless Steel Sheet Metal Screws
- 5583: 45° Elbow

Installation:

1. Install the 5400, 5450, or 5500 model in the desired location (see Owner's Manual). Make sure all plumbing and electrical work has been completed within the available space shown in the diagram. To ease plumbing, the outdoor cover includes a 45° elbow for the inlet.

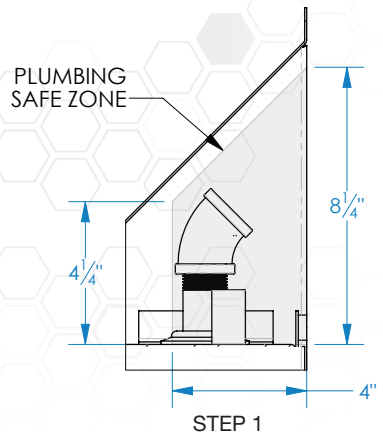

2. Slide the Model 5680A Outdoor Cover down over the 5400, 5450, or 5500. The internal tabs of the cover should rest on top of the cabinet and both sides of the cover should be slightly below the bottom edge of the cabinet. If not, investigate why and correct the issue before proceeding to the next step.
3. Push the cover flush against the mounting surface and, using a clamp or a helper, squeeze the bottom sides of the cover so they are tight against the cabinet. Then, mark all six (6) flange hole locations on the mounting surface.
4. Remove the clamp (if used) and lift the cover off of the cabinet. Then, drill all six (6) hole locations into the mounting surface, according to your chosen fastener's installation requirements.
5. To prevent rain and snow from getting behind the cabinet, run a bead of caulk or sealant around the back side of the flange. Then, carefully slide the cover over the cabinet making sure there is a gap between the flange and the wall so that the caulk or sealant does not smear down the wall.
6. When the cover comes to rest on top of the cabinet push the cover against the wall and use a clamp, or a helper to squeeze the bottom sides of the cover tight to the sides of the cabinet like in step 3.
7. Install the tie-down (5669) to the bottom of the cover using the four (4) $\frac{5}{16}$ " sheet metal screws (5582). Tighten to a maximum torque of 50 in. lbs. Then, remove the clamp (if used).
8. Install the six (6) wall mounting fasteners (not provided).

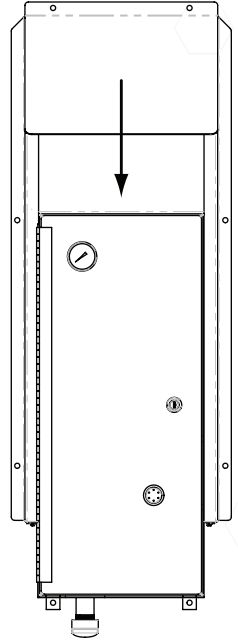

Model 5690A

Mounting Kit Assembly and Outdoor Cover

INSTALLATION INSTRUCTIONS

The Model 5690A Mounting Kit is to be used on **COLLECT_{AND}DRAIN 5400, 5450, and 5500 models that utilize the Model 5680A Outdoor Cover and are mounted to non-standard walls (I-beams or round bollards), or where standoffs are required on a standard wall.** The mounting kit installs behind the COLLECT_{AND}DRAIN cabinet so the outdoor cover can be properly secured and the cabinet can be fully sealed and protected from the elements.

Inspection:

Unpack the Model 5690A Mounting Kit and carefully inspect it for any damage caused during shipping. Verify that all contents below are included.

Each M5690A includes:

- 5546: $\frac{5}{16}$ " Washers (28)
- 5689: $\frac{5}{16}$ " x $1\frac{3}{4}$ " Bolts (4)
- 5691: Mounting Plate (1)
- 5692: Flashing with Holes
- 5693: Cross Bracket
- 5694: $\frac{5}{16}$ " x $\frac{3}{4}$ " Bolts (12)
- 5695: $\frac{5}{16}$ " Nuts (20)
- 5696: Blank Flashing
- 5697-17: Struts (2)
- 5698: Strut Nuts (4)
- 5699: Square Strut Washers (4)

Installation:

1. Install the struts to the desired surface 29" apart vertically on center. If possible, use the indicated slots of the mounting plate (5691) as a template. Mounting hardware for the struts are not provided.
2. Thread the four longer bolts (5689) all the way into the back (smooth side) of the four strut nuts (5698).
3. Slide the grooves of the strut nut into the strut channel and secure it by using a square washer (5699) and nut (5695). Hand-tighten the strut nut assembly so it can slide freely within the strut. Repeat for the remaining three strut nuts.

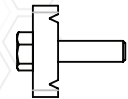
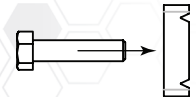

STEP 2

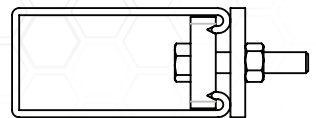

STEP 3

4. Using the mounting plate (5691), align the strut nut assemblies (two per strut) up with the mounting slots on the plate. Once they are in their desired position, remove the mounting plate and tighten the strut nuts.
5. Place the mounting plate (5691) back onto the strut nut assemblies.
6. Install the COLLECT_{AND}DRAIN cabinet over the mounting plate onto the strut nut assemblies (discard the rubber spacers provided with the cabinet). Once the cabinet is plumb, secure each mounting tab using a washer (5546) and a nut (5695). *AGF recommends using the aid of a helper when installing the COLLECT_{AND}DRAIN cabinet.*

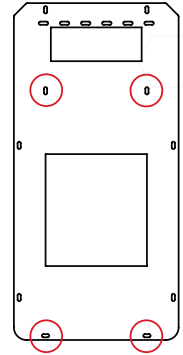
STEP 1 & 4

7. Ensure the electrical conduit and plumbing will be in the safe zone above the cabinet where they can pass through the rectangular opening of the mounting plate. Then, on the rear of the mounting plate test fit the flashing (5692) by lining it up with the six mounting slots at the top and making sure it lines up with the conduit and plumbing. If the conduit and plumbing do not line up with the openings in the flashing use the blank flashing (5696) and cut custom openings to fit.

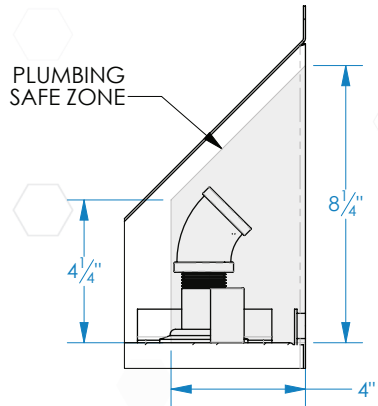
STEP 7

8. Once the flashing fits over the conduit and plumbing, place the cross bracket (5693) over the flashing and bolt the cross bracket and flashing to the rear of the mounting plate using the six bolts (5694), twelve washers (5546), and six nuts (5695). Use the slots in the mounting plate to adjust the flashing as needed then, tighten.

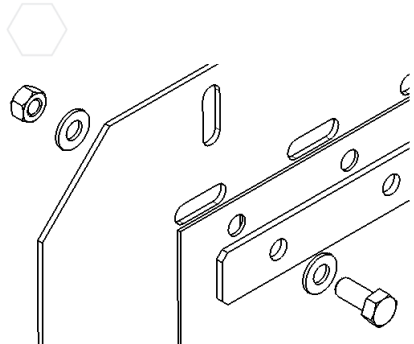
STEP 8

9. Slide the COLLECT_{AND}DRAIN Model 5680 Outdoor Cover over the cabinet. The internal stops of the outdoor cover should rest on top of the cabinet and both sides of the cover should be slightly below the bottom of the cabinet with the mounting holes of the flange lining up with the mounting holes of the plate. If the mounting holes of the flange do not line up with the mounting holes of the plate, investigate why and correct the issue before proceeding to the next step.
10. With the outdoor cover pulled slightly away from the mounting plate, run a bead of caulk or sealant around the back of the flange, and across the top of the cross bracket on the rear of the mounting plate.
11. Push the outdoor cover against the mounting plate. Using the six bolts (5694), twelve washers (5546), and six nuts (5695) hand-tighten the the outdoor cover onto the mounting plate.
12. Using a clamp or the aid of a helper, squeeze the bottom sides of the outdoor cover so they are tight to the cabinet and install the tie-down (included with the outdoor cover) to the bottom of the outdoor cover using the four sheet metal screws (5582), provided with the outdoor cover, to a maximum of 50 in. lbs. Then, remove the clamp (if used).
13. Finish by tightening the bolts on the cover's flange to the mounting plate.



AGF Manufacturing
100 Quaker Lane • Malvern, PA 19355

Phone: 610-240-4900
techsupport@agfmfg.com

www.agfmfg.com